

DATA SHEET

Ø 5.10 (XL)

ROTARY VANE VACUUM PUMPS

oil-lubricated

air-cooled

MAKE IT BECKER.



O 5.10 XL WITH 0.5 L TANK

- Including motors without Mate-N-Lok power connection

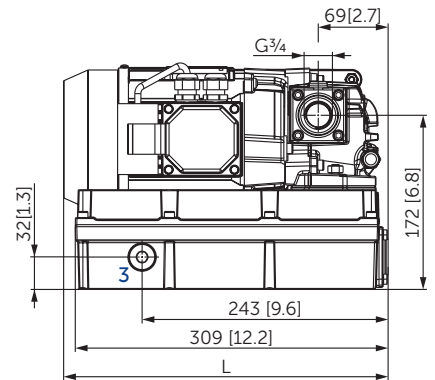
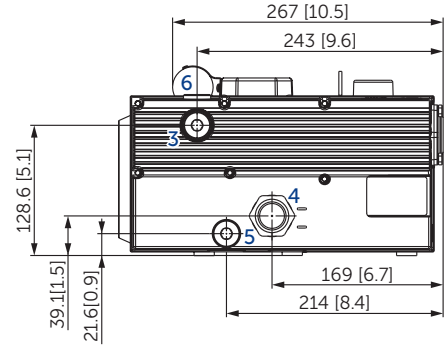
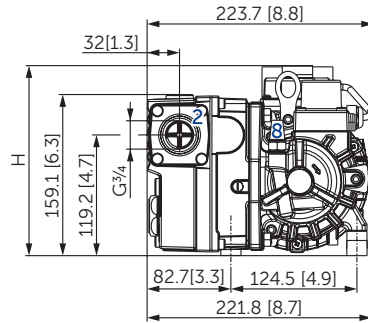
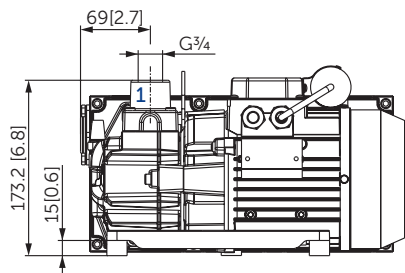
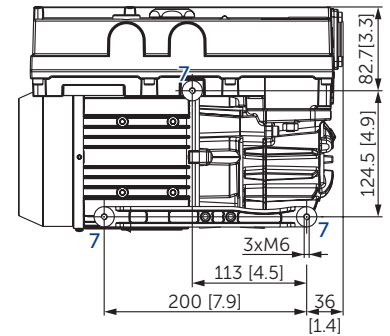
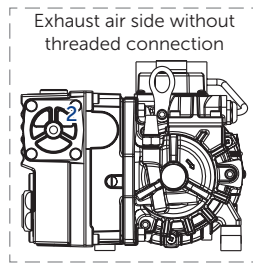
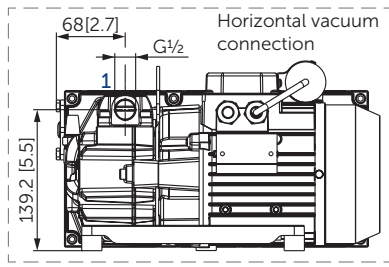

- 1 Vacuum connection vertical (G^{3/4}) or horizontal (G^{1/2})
- 2 Exhaust air side with or without threaded connection (G^{3/4})
- 3 Oil filler cap
- 4 Oil sight glass
- 5 Screw plug for oil drain
- 6 Capacitor for 1~ motors
- 7 Rubber buffer position
- 8 Optional gas ballast valve
 - Non-return valve and oil separator are integrated
 - The motor illustration may vary
 - Dimensions in mm [inch]

	Nominal capacity		Vacuum absolute		Emission sound pressure level ¹⁾		Weight incl. motor	Oil (Oil tank)
	m ³ /h		mbar		dB(A)			
	50 Hz	60 Hz	50 Hz	60 Hz	50 Hz	60 Hz	kg	l
O 5.10 XL	10.5	12.5	2	2	58.5	64	≈18.5	0.5
O 5.10	10.5	12.5	2	2	58.5	64	≈17.0	0.3

¹⁾ According to DIN EN ISO 11203, accuracy class of measurement: class 2, extended measurement uncertainty: 3 dB 1 m [39.4 inch] distance, at medium load, vacuum connection piped, exhaust side open

1~ Motors											H	L
#	50 Hz				60 Hz				Version	Weight kg	mm	
	kW	V	min ⁻¹	A	kW	V	min ⁻¹	A			[inch]	[inch]
01	0.37	220–240	2790–2820	2.5	0.45	220–240	3270–3340	3.2	IP 55 • ISO F • bimetal	9.4	187.7 [7.4]	320.5 [12.6]
02	0.55	100–110	2770–2810	9.0–8.9	0.66	100–120	3240–3370	10.4–9.3	UL • CSA IP 55 • ISO F • bimetal	10.8	187.7 [7.4]	320.5 [12.6]

1~ Motors with Mate-N-Lok power connection											H	L
#	50 Hz				60 Hz				Version	Weight kg	mm	
	kW	V	min ⁻¹	A	kW	V	min ⁻¹	A			[inch]	[inch]
03	0.37	220–240	2700–2790	2.7–2.6					IP 55 • ISO F • bimetal Mate-N-Lok	8.2	158 [6.2]	291 [11.5]
04	0.37	220–240	2790–2820	2.5	0.45	220–240	3270–3340	3.2	IP 55 • ISO F • bimetal Mate-N-Lok	9.4	158 [6.2]	320.5 [12.6]

3~ Motoren											H	L
#	50 Hz				60 Hz				Version	Weight kg	mm	
	kW	V	min ⁻¹	A	kW	V	min ⁻¹	A			[inch]	[inch]
05	0.37	Δ230/Y400	2860	1.7/1.0	0.45	Δ265/Y460	3440	1.7/1.0	IE2 ¹⁾ IP55 • ISO F • bimetal	7.7	177 [7]	291.5 [11.5]
						Δ230/Y400	3370	1.9/1.1				
06	0.37	Δ200/Y350	2860	2.1/1.2	0.45	Δ200/Y350	3380	2.3/1.3	IP55 • ISO F • bimetal	7.7	177 [7]	291.5 [11.5]
						Δ220/Y380	3410	2.1/1.2				
07	0.37	Y400	2860	1.0	0.45	YY208–230	3390–3440	2.1–2.0	UL • CSA IP55 • ISO F • bimetal	7.8	177 [7]	291.5 [11.5]
						Y460	3440	1.0				

¹⁾ Details see type plate

• Type plate data on current consumption and rotation speed of the motors may vary. Tolerance -1.5/+2% in each case.

+ VARIANTS AND ACCESSORIES

O 5.10 WITH 0.3 L TANK

- Including motors without Mate-N-Lok power connection

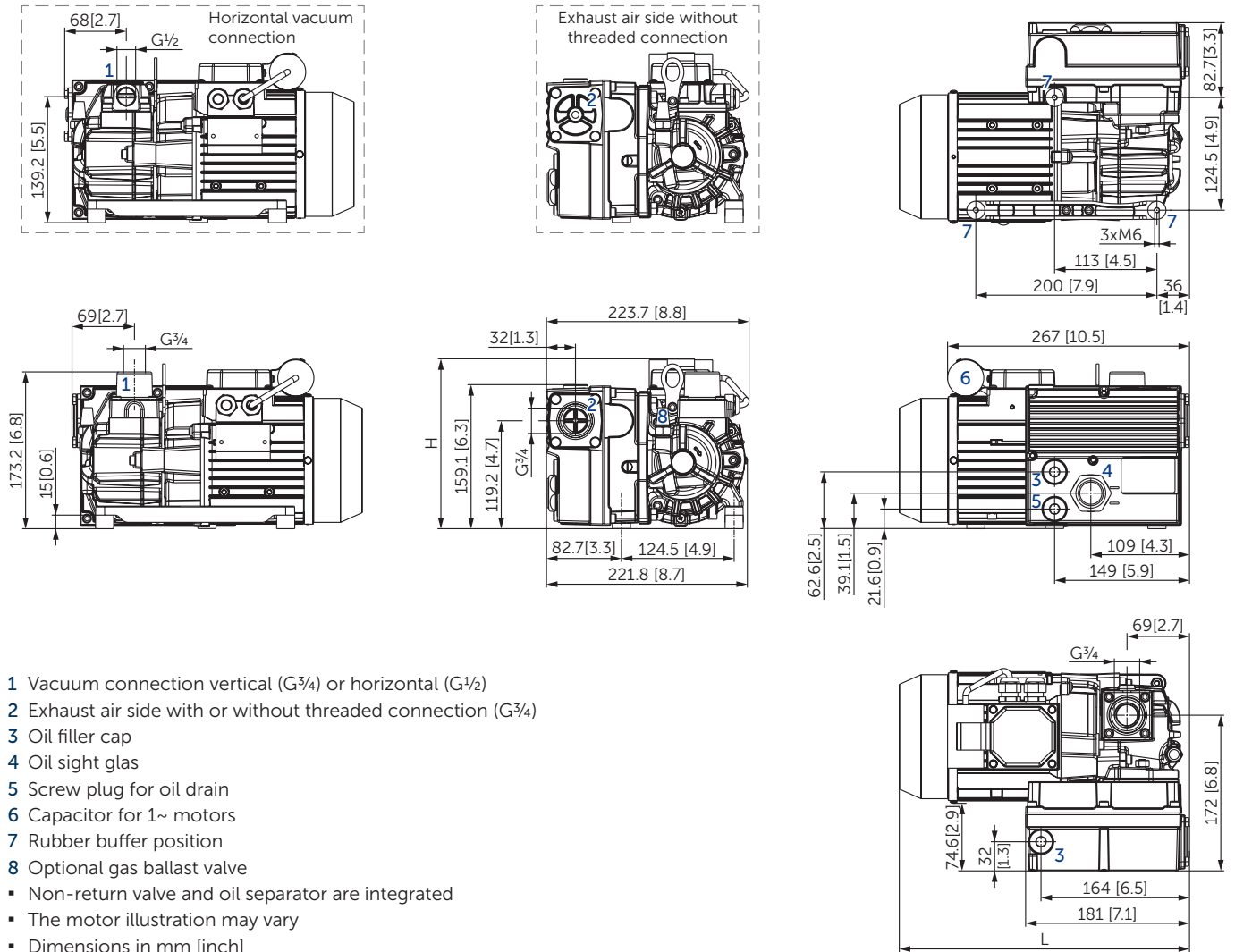

O 5.10 XL WITH 0.5 L TANK AND MATE-N-LOK POWER CONNECTION

- Motor #03 or #04 included

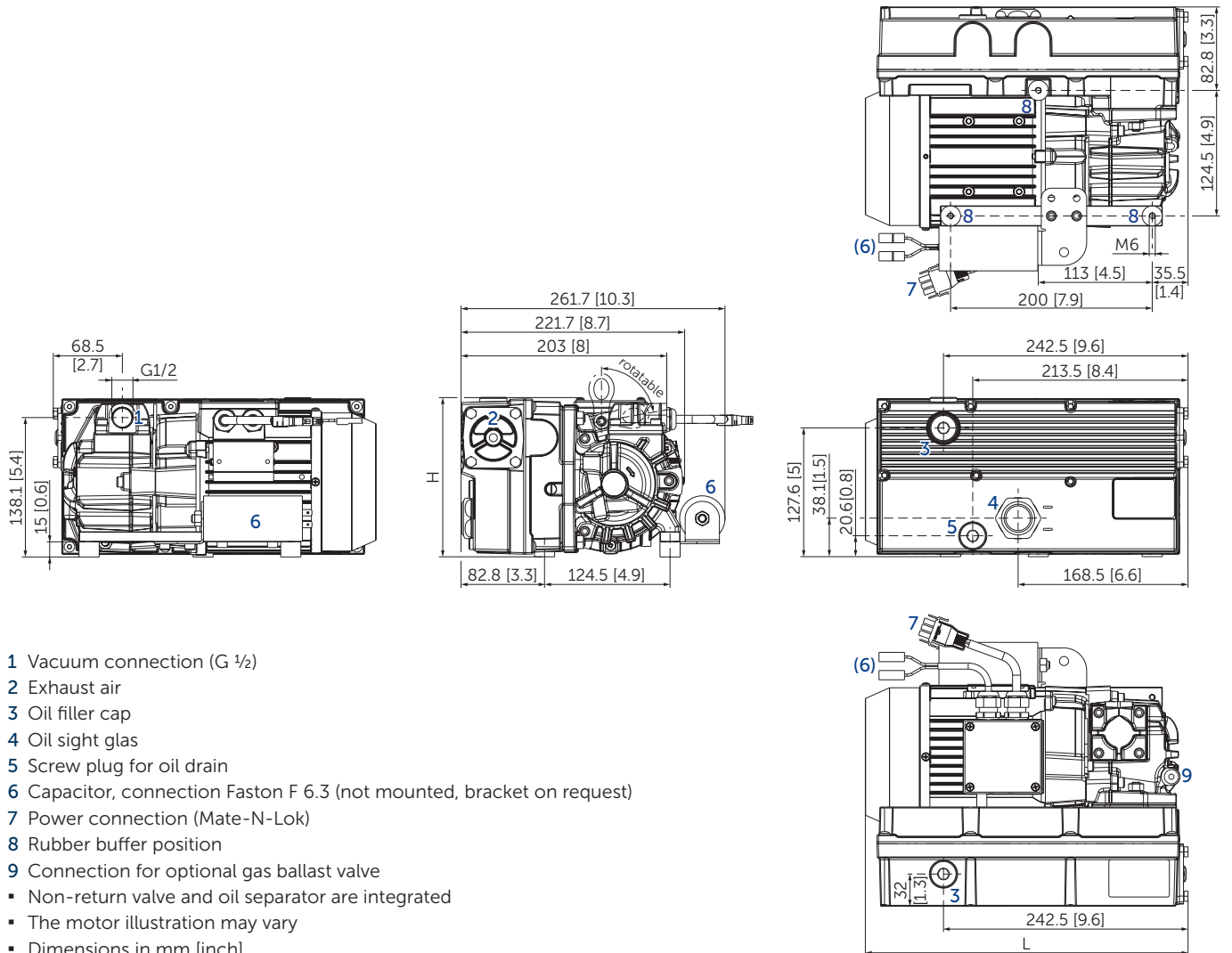

- 1 Vacuum connection (G 1/2)
- 2 Exhaust air
- 3 Oil filler cap
- 4 Oil sight glass
- 5 Screw plug for oil drain
- 6 Capacitor, connection Faston F 6.3 (not mounted, bracket on request)
- 7 Power connection (Mate-N-Lok)
- 8 Rubber buffer position
- 9 Connection for optional gas ballast valve
 - Non-return valve and oil separator are integrated
 - The motor illustration may vary
 - Dimensions in mm [inch]

O 5.10 WITH 0.3 L TANK AND MATE-N-LOK POWER CONNECTION

- Motor #03 or #04 included

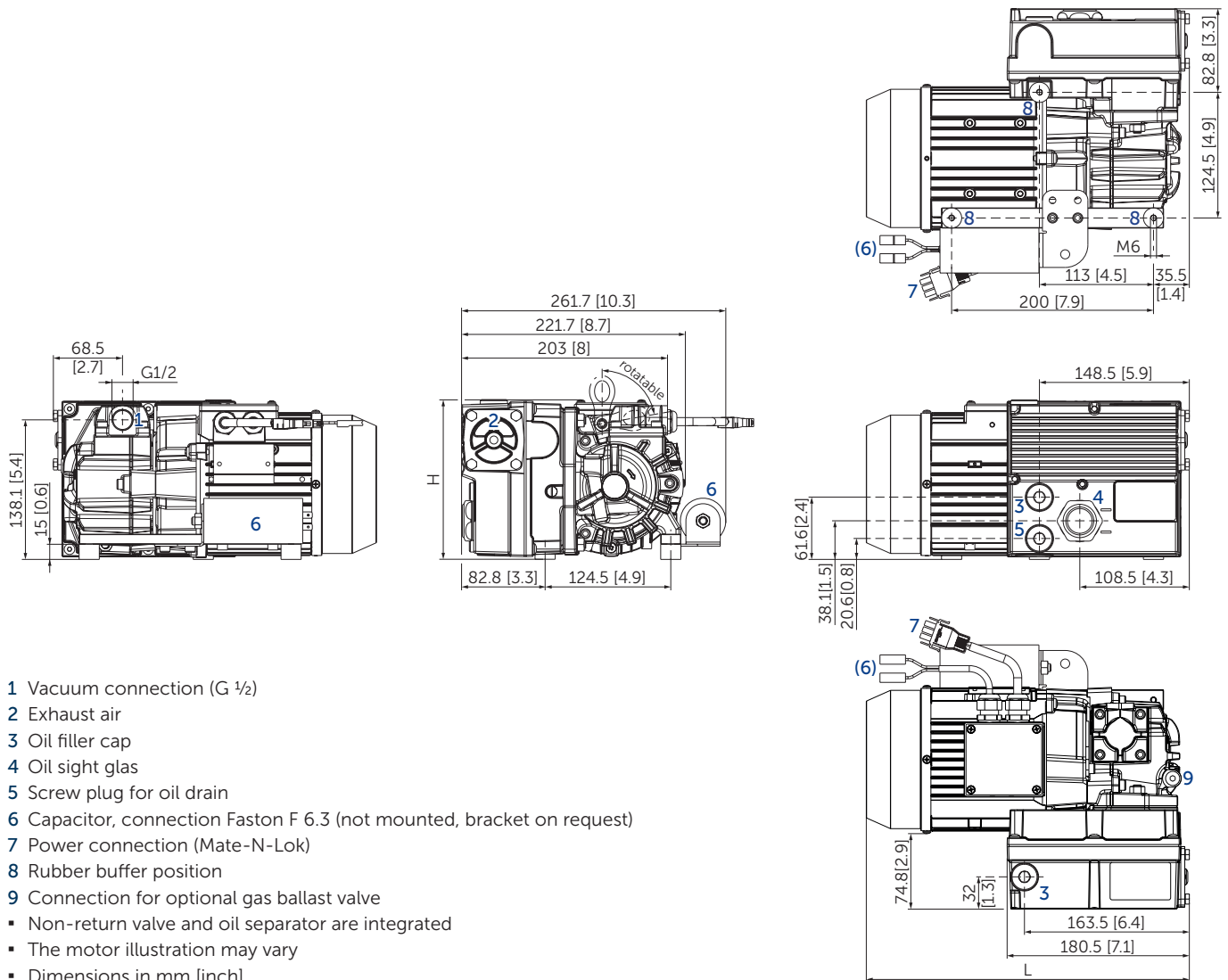

- 1 Vacuum connection (G 1/2)
- 2 Exhaust air
- 3 Oil filler cap
- 4 Oil sight glass
- 5 Screw plug for oil drain
- 6 Capacitor, connection Faston F 6.3 (not mounted, bracket on request)
- 7 Power connection (Mate-N-Lok)
- 8 Rubber buffer position
- 9 Connection for optional gas ballast valve
 - Non-return valve and oil separator are integrated
 - The motor illustration may vary
 - Dimensions in mm [inch]

GAS BALLAST VALVE

- Version for small amounts of moisture, vacuum <3 mbar
- Version for higher amounts of moisture, vacuum <20 mbar

BECKER LUBE¹⁾

- | | | | |
|-----------------------|-------------------------|--------------------------------------|---------------------------------------|
| ▪ M 68 mineral | ▪ S 68 synthetic | ▪ SL 68 food (food packaging) | ▪ SM 68 food (food processing) |
| ▪ M 32 mineral | ▪ S 32 synthetic | ▪ SL 32 food (food packaging) | ▪ SM 32 food (food processing) |

¹⁾ See operating instructions



MAKE IT BECKER.